

INTRODUCING YET ANOTHER SCINTILLATING  
PROJECT FROM



**SRI SADGURU**

CONSTRUCTIONS

[www.srisadguruconstructions.com](http://www.srisadguruconstructions.com)

GET READY TO BE BLOWN AWAY BY BEAUTY ONLY AT ...



**SLOKA**

A A V A A S



*Elevate your life!!!  
Live every moment to the fullest  
as every corner captivates  
your imagination.*



The lavish secured community nestled in the heart of Nizampet. The luxurious ambiance takes life to a new elegance. You can't help but wonder at this project transforming engineering into a work of art. Stunning elevations, shining common area, well defined spaces and large flats- more than you can ask for. Here, intelligent design fuses with breathtaking natural vistas to ensure ample cross ventilation, lots of natural lights and impressive aesthetics.

Every detail about **SLOKA AAVAAS** apartments is thoughtfully crafted and designed with you in mind. A collection of 2 bedroom units, are available for your indulgence.

**SLOKA AAVAAS ..** a seamless integration of quality, style and space, where you feel relaxed and rejuvenated with all the best things life has to offer. A tranquil place that lets you live in ways of illuminating and nurturing you. The interiors are designed keeping in mind, the optimum utilization of space in every apartment.

Our highly motivated team uses skills, energy and creative spirit to bring novelty into real estate and other social assets.





**SLOKA**  
A A V A A S





# TYPICAL FLOOR PLAN & PARKING PLAN

## NORTH - SUKRUTH AAVAAS

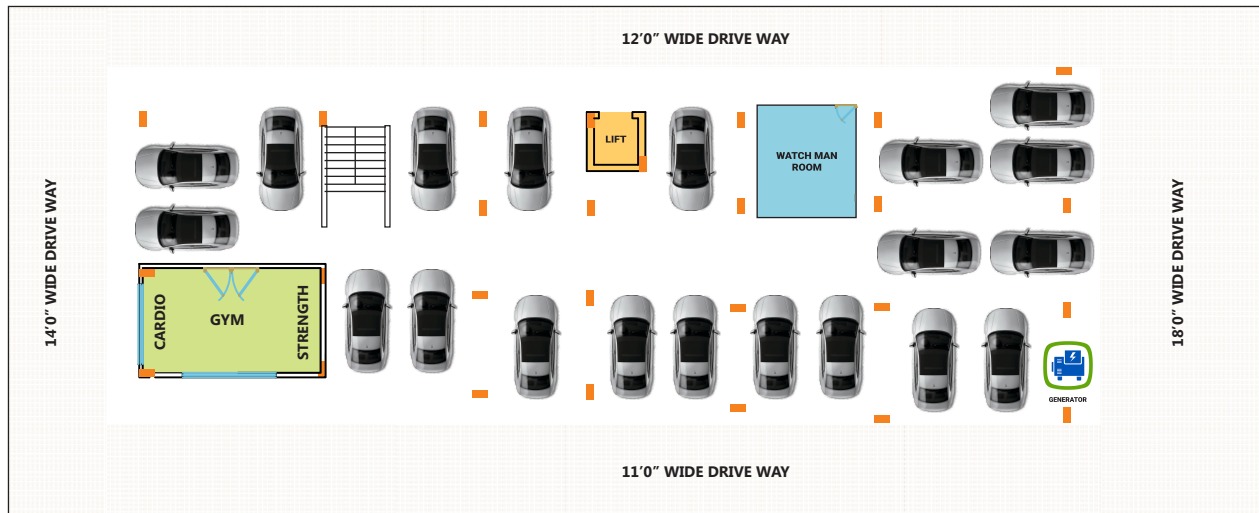
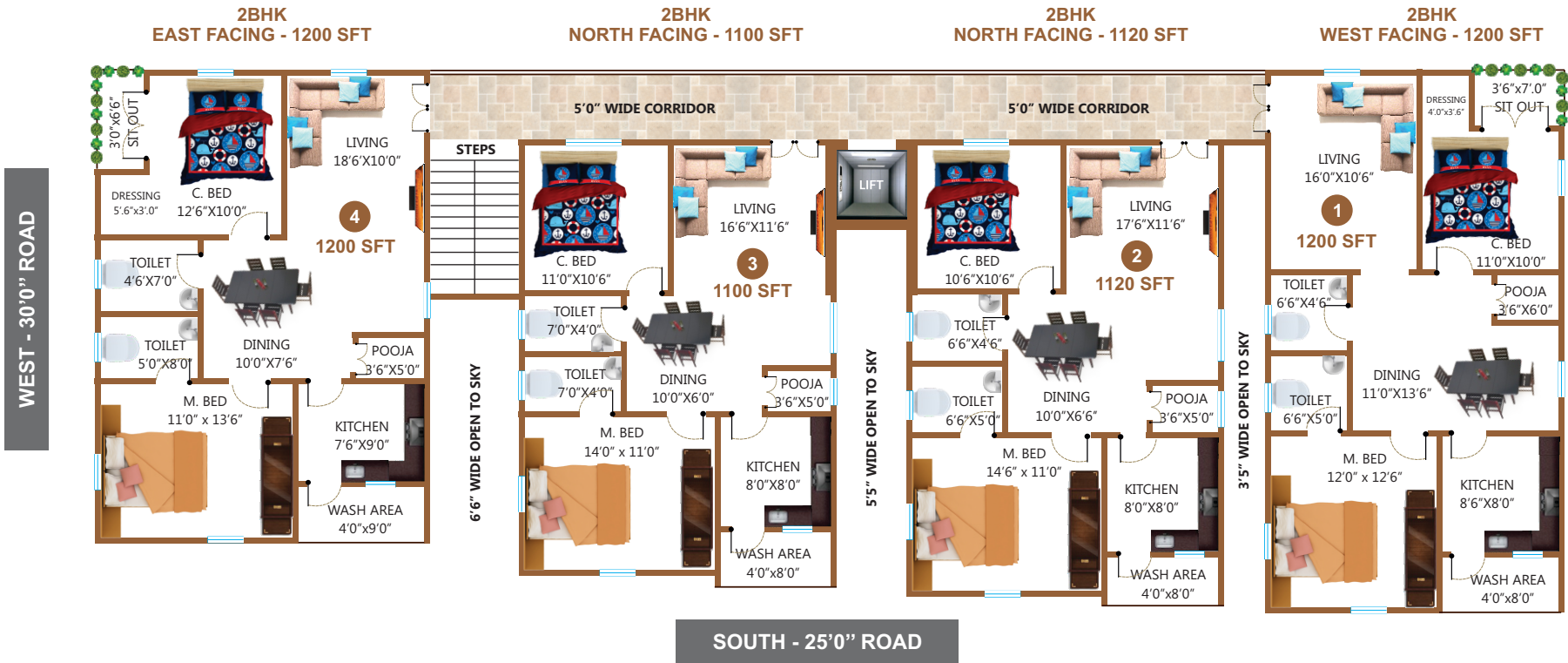



## SPECIFICATIONS

### FRAMED STRUCTURE

R.C.C framed structure to withstand wind & seismic loads

SUPERSTRUCTURE - First Class Brick Masonry in Cement Mortar

PLASTERING - Two coats of plastering with sponge finishing

### Wood Work

**MAIN DOOR** Best teak wood frame & shutter aesthetically designed with melamine polishing and designer hardware of reputed make

**INTERNAL DOORS** Best teak wood frame with moulded paneled shutter doors with reputed make fittings

**WINDOWS** UPVC Window system with tinted Float Glass with suitable finishes as per design

### Painting

**EXTERNAL** Two coats exterior acrylic emulsion paint of Asian /ICI or equivalent make over one coat of primer

**INTERNAL** Smooth wall putty finish with acrylic emulsion paint of Asian/ICI or equivalent over a coat of primer

### Floors

Living, Dining, Bedroom & Kitchen: First quality Vitrified Tiles (24"x24")

**BATHROOMS** Acid-resistant anti-skid Ceramic Tiles

**KITCHEN** Black Granite platform and 2' height digital tiles

**ELECTRICITY** Concealed copper wiring in conduits for lights, fans, power plug points wherever necessary

**PLUMBING** Superior quality GI/CPVC piping with special fitting as per relevant IS specification sanitary and Rain water piping

**WATER** 24 hours water supply is ensured with water tank

**LIFT** 6 - Passengers lift with standard make

**SECURITY** 24/7 Watchmen security with CC Camera Monitoring, Intercom and compound wall fencing

**REGISTRATION** Registration or any Govt. charges will be borne by the customer

**Bharathi**  
CEMENT

**KONE**

**Finolex**

**legrand**

**CERA**

**SUDHAKAR**  
PIPES & FITTINGS

**AGL**  
TILES WORLD

**asianpaints**



**ASTRAL**  
where INNOVATION flows

**ANCHOR**  
by Panasonic



**JOHNSON**  
Not just tiles, Lifestyles.

NEARING COMPLETION

# Swastik Aavaas

WHERE MEMORIES ARE MADE AND  
LAUGHTER IS SHARED

Swastik Aavaas prominent for impeccable quality, utmost attention to detail ... the first launch from Sri Sadguru Constructions is on the verge of completion.

2  happy families awaiting to move in to their new  nests.

*Come experience the quality of fine living !!!!!*





DEVELOPMENT IN PROCESS



# SUKRUTH AAVAAS

WHERE ROYALTY MEETS AFFORDABILITY



**SRI SADGURU**  
CONSTRUCTIONS





## Amenities

- ▶ 24x7 security services
- ▶ Gym
- ▶ Association meeting hall
- ▶ Children play area
- ▶ CCTV Surveillance
- ▶ Intercom connectivity
- ▶ Solar fenced boundary wall
- ▶ 6 Passengers KONE elevator
- ▶ Power backup
- ▶ SS railing with wide stair case
- ▶ Granite, fall ceiling & LED lamps in every corridor & parking level
- ▶ Pre-fixed individual water meters

## Project Highlights

- ▶ Vaastu Shastra compliance
- ▶ GHMC approved as per **RERA** Act
- ▶ Quality Construction as per ISO Standards
- ▶ Car parking with ample space
- ▶ Eco friendly design and construction
- ▶ Smooth aesthetic finish with leak proof joints.
- ▶ Fast construction ensures timely delivery
- ▶ Well planned spaces with good ventilation
- ▶ Termite control & chemical treatment from pre constrative stages
- ▶ Superior **A** Grade quality materials with fine finishing
- ▶ Wide driveways

## Location Map



### Site Address:

Plot No. 82, 83 & 84 Survey No. 63 & 66, Mitra Hills, Hydernagar, Hyderabad - 90, Telangana, India

### Registered Office:

#404, Padmaja's Jhansi Enclave, Bhagyanagar Colony, Opp: KPHB, Kukatpally, Hyderabad - 72, Telangana, India.  
E-mail: srisadguruconstructions@yahoo.com | www.srisadguruconstructions.com

**Call : 98481 95933** | E-mail: [kotinisrinivas@gmail.com](mailto:kotinisrinivas@gmail.com)

Note: This brochure is only a conceptual presentation of the project and not a legal offering. The promoters reserve the right to make changes in plans, specifications and elevation as deemed fit.